

# Ball Bearings

Double Row  
Metric Series

**42, 43**

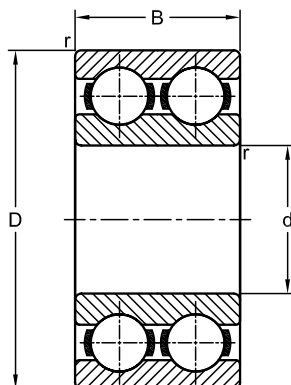

Dimensions				Load Rating		AEC Bearing	K
mm				kN			
d	D	B	r	Dynamic (C)	Static (C <sub>0</sub> )		
15	35	14	0.6	11.9	7.5	4202	
	42	17	1.0	14.8	9.5	4302	
17	40	16	0.6	14.8	9.5	4203	
	47	19	1.0	19.5	13.2	4303	•
20	47	18	1.0	17.8	12.5	4204	
	52	21	1.1	23.4	16.0	4304	
25	52	18	1.0	19.0	14.6	4205	•
	62	24	1.1	31.9	22.4	4305	
30	62	20	1.0	26.0	20.8	4206	•
	72	27	1.1	41.0	30.0	4306	
35	72	23	1.1	35.1	28.5	4207	•
	80	31	1.5	50.7	38.0	4307	
40	80	23	1.1	37.1	32.5	4208	•
	90	33	1.5	55.9	45.0	4308	
45	85	23	1.1	39.0	36.0	4209	•
	100	36	1.5	68.9	56.0	4309	
50	90	23	1.1	41.0	40.0	4210	•
	110	40	2.0	81.9	69.5	4310	
55	100	25	1.5	44.9	44.0	4211	
	120	43	2.0	97.5	83.0	4311	
60	110	28	1.5	57.2	55.0	4212	•
	130	46	2.1	112.0	98.0	4312	
65	120	31	1.5	67.6	67.0	4213	
	140	48	2.1	121.0	106.0	4313	
70	125	31	1.5	70.2	73.5	4214	
	150	51	2.1	138.0	125.0	4314	
75	130	31	1.5	72.8	80.0	4215	
	160	55	2.1	156.0	143.0	4315	

Dimensions				Load Rating		AEC Bearing	K
mm				kN			
d	D	B	r	Dynamic (C)	Static (C <sub>0</sub> )		
80	140	33	2.0	80.6	90.0	4216	
85	150	36	2.0	93.6	102.0	4217	
90	160	40	2.0	112.0	122.0	4218	
100	180	46	2.1	140.0	156.0	4220	