

Cylindrical Roller Bearings

Double Row
Metric Series

NN, NNU

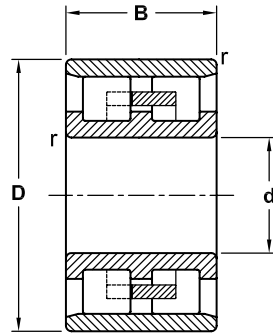

NN

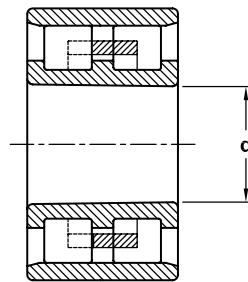

NN (Tapered Bore)

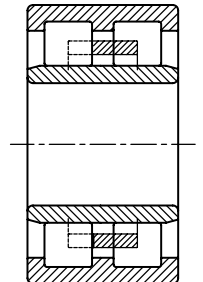

NNU

Dimensions				Load Rating		AEC Bearing	M	K
mm				kN				
d	D	B	r	Dynamic (C)	Static (C ₀)			
30	55	19	1.0	29.0	34.0	NN 3006	•	•
35	62	20	1.0	35.5	44.0	NN 3007	•	•
40	68	21	1.0	45.0	58.5	NN 3008	•	•
45	75	23	1.0	54.0	72.0	NN 3009	•	•
50	80	23	1.0	57.0	80.0	NN 3010	•	•
55	90	26	1.1	72.0	100.0	NN 3011	•	•
60	95	26	1.1	75.0	110.0	NN 3012	•	•
65	100	26	1.1	76.5	116.0	NN 3013	•	•
70	110	30	1.1	98.0	150.0	NN 3014	•	•
75	115	30	1.1	100.0	156.0	NN 3015	•	•
80	125	34	1.1	120.0	186.0	NN 3016	•	•
85	130	34	1.1	125.0	200.0	NN 3017	•	•
90	140	37	1.5	140.0	224.0	NN 3018	•	•
95	145	37	1.5	143.0	236.0	NN 3019	•	•
100	140	40	1.1	129.0	255.0	NNU 4920	•	•
	150	37	1.5	146.0	245.0	NN 3020	•	•
105	145	40	1.1	129.0	260.0	NNU 4921	•	•
	160	41	2.0	190.0	310.0	NN 3021	•	•
110	150	40	1.1	132.0	270.0	NNU 4922	•	•
	170	45	2.0	220.0	360.0	NN 3022	•	•
120	165	45	1.1	176.0	340.0	NNU 4924	•	•
	180	46	2.0	232.0	390.0	NN 3024	•	•
130	180	50	1.5	190.0	390.0	NNU 4926	•	•
	200	52	2.0	290.0	500.0	NN 3026	•	•
140	190	50	1.5	190.0	400.0	NNU 4928	•	•
	210	53	2.0	300.0	520.0	NN 3028	•	•

Dimensions				Load Rating		AEC Bearing	M	K
mm				kN				
d	D	B	r	Dynamic (C)	Static (C ₀)			
150	210	60	2.0	325.0	655.0	NU 4930	•	•
	225	56	2.1	335.0	585.0	NN 3030	•	•
160	220	60	2.0	335.0	680.0	NU 4932	•	•
	240	60	2.1	375.0	670.0	NN 3032	•	•
170	230	60	2.0	340.0	695.0	NU 4934	•	•
	260	67	2.1	450.0	800.0	NN 3034	•	•
180	250	69	2.0	405.0	850.0	NU 4936	•	•
	280	74	2.1	570.0	1000.0	NN 3036	•	•
190	260	69	2.0	405.0	880.0	NU 4938	•	•
	290	75	2.1	585.0	1040.0	NN 3038	•	•
200	280	80	2.1	490.0	1040.0	NU 4940	•	•
	310	82	2.1	655.0	1200.0	NN 3040	•	•
220	300	80	2.1	510.0	1140.0	NU 4944	•	•
	340	90	3.0	800.0	1460.0	NN 3044	•	•
240	320	80	2.1	530.0	1200.0	NU 4948	•	•
	360	92	3.0	850.0	1560.0	NN 3048	•	•
260	360	100	2.1	750.0	1700.0	NU 4952	•	•
	400	104	4.0	1060.0	2000.0	NN 3052	•	•
280	380	100	2.1	765.0	1800.0	NU 4956	•	•
	420	106	4.0	1080.0	2080.0	NN 3056	•	•
300	420	118	3.0	1040.0	2400.0	NU 4960	•	•
	460	118	4.0	1270.0	2400.0	NN 3060	•	•
320	440	118	3.0	1060.0	2550.0	NU 4964	•	•
	480	121	4.0	1320.0	2600.0	NN 3064	•	•
340	520	133	5.0	1630.0	3250.0	NN 3068	•	•
360	540	134	5.0	1660.0	3350.0	NN 3072	•	•
380	560	135	5.0	1700.0	3450.0	NN 3076	•	•
400	600	148	5.0	2160.0	4500.0	NN 3080	•	•
420	620	150	5.0	2120.0	4500.0	NN 3084	•	•
440	650	157	6.0	2450.0	5100.0	NN 3088	•	•
460	680	163	6.0	2600.0	5400.0	NN 3092	•	•
480	700	165	6.0	2700.0	5850.0	NN 3096	•	•
500	720	167	6.0	2650.0	5850.0	NN 30/500	•	•