

Cylindrical Roller Bearings

Thrust
Inch Series

T, AT

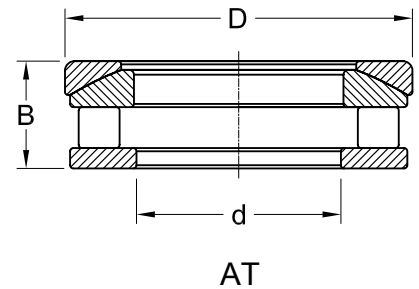
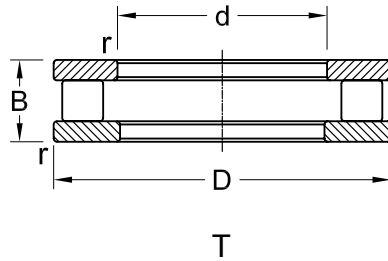
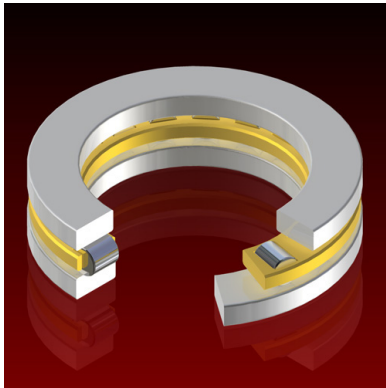

Dimensions				Load Rating		AEC Bearing
inch (mm)				kN		
d	D	B	r	Dynamic (C)	Static (C ₀)	
1.000	2.125	0.812	0.0315 (0.8)	44.5	38.1	T 601
	2.250	1.062	0.0315 (0.8)	44.5	38.1	AT 601
1.062	2.125	0.812	0.0315 (0.8)	44.5	38.1	T 602
	2.250	1.062	0.0315 (0.8)	44.5	38.1	AT 602
1.125	2.250	0.812	0.0315 (0.8)	51.2	52.1	T 603
	2.375	1.062	0.0315 (0.8)	51.2	52.1	AT 603
1.187	2.250	0.812	0.0315 (0.8)	51.2	52.1	T 604
	2.375	1.062	0.0315 (0.8)	51.2	52.1	AT 604
1.250	2.375	0.812	0.0315 (0.8)	56.5	57.8	T 605
	2.500	1.062	0.0315 (0.8)	56.5	57.8	AT 605
1.312	2.375	0.812	0.0315 (0.8)	56.5	57.8	T 606
	2.500	1.062	0.0315 (0.8)	56.5	57.8	AT 606
1.375	2.875	0.812	0.0315 (0.8)	69.4	96.1	T 607
	3.000	1.062	0.0315 (0.8)	69.4	96.1	AT 607
1.437	2.875	0.812	0.0315 (0.8)	69.4	96.1	T 608
	3.000	1.062	0.0315 (0.8)	69.4	96.1	AT 608
1.500	3.000	0.812	0.0315 (0.8)	75.2	105.0	T 609
	3.125	1.062	0.0315 (0.8)	75.2	105.0	AT 609
1.562	3.000	0.812	0.0315 (0.8)	75.2	105.0	T 610
	3.125	1.062	0.0315 (0.8)	75.2	105.0	AT 610
1.625	3.250	1.000	0.0630 (1.6)	109.0	136.0	T 611
	3.375	1.312	0.0630 (1.6)	109.0	136.0	AT 611
1.687	3.250	1.000	0.0630 (1.6)	109.0	136.0	T 612
	3.375	1.312	0.0630 (1.6)	109.0	136.0	AT 612
1.750	3.375	1.000	0.0630 (1.6)	118.5	150.0	T 613
	3.500	1.312	0.0630 (1.6)	118.5	150.0	AT 613
1.812	3.375	1.000	0.0630 (1.6)	118.5	150.0	T 614
	3.500	1.312	0.0630 (1.6)	118.5	150.0	AT 614
1.875	3.500	1.000	0.0630 (1.6)	118.5	150.0	T 615
	3.625	1.312	0.0630 (1.6)	118.5	150.0	AT 615
1.937	3.500	1.000	0.0630 (1.6)	118.5	150.0	T 616
	3.625	1.312	0.0630 (1.6)	118.5	150.0	AT 616

Dimensions				Load Rating		AEC Bearing
inch (mm)				kN		
d	D	B	r	Dynamic (C)	Static (C ₀)	
2.000	3.625	1.000	0.0630 (1.6)	118.5	150.0	T 617
	3.750	1.312	0.0630 (1.6)	118.5	150.0	AT 617
2.125	3.750	1.000	0.0630 (1.6)	128.0	164.0	T 618
	3.875	1.312	0.0630 (1.6)	128.0	164.0	AT 618
2.250	3.875	1.000	0.0630 (1.6)	137.0	178.0	T 619
	4.000	1.312	0.0630 (1.6)	137.0	178.0	AT 619
2.375	4.000	1.000	0.0630 (1.6)	142.0	178.0	T 620
	4.125	1.312	0.0630 (1.6)	142.0	178.0	AT 620
2.500	4.125	1.000	0.0630 (1.6)	148.0	191.0	T 621
	4.250	1.312	0.0630 (1.6)	148.0	191.0	AT 621
2.625	4.343	1.000	0.0630 (1.6)	165.0	205.0	T 622
	4.530	1.312	0.0630 (1.6)	165.0	205.0	AT 622
2.750	4.468	1.000	0.0630 (1.6)	144.0	218.0	T 623
	4.655	1.312	0.0630 (1.6)	144.0	218.0	AT 623
3.000	4.718	1.000	0.0630 (1.6)	178.0	232.0	T 624
	4.968	1.312	0.0630 (1.6)	178.0	232.0	AT 624
3.250	4.968	1.000	0.0630 (1.6)	174.0	232.0	T 625
	5.218	1.312	0.0630 (1.6)	174.0	232.0	AT 625
3.500	5.218	1.000	0.0630 (1.6)	183.0	245.0	T 626
	5.468	1.312	0.0630 (1.6)	183.0	245.0	AT 626