

# Flexible Roller Bearings

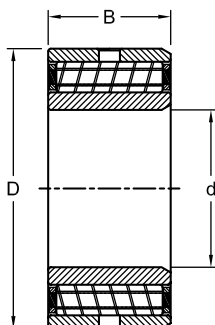

Metric Series

**FLW**



FLW

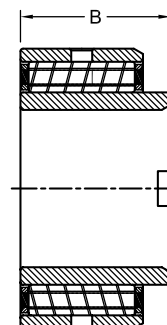

15000

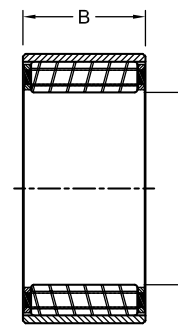

45000

Dimensions			Load Rating		AEC Bearing
mm			kN		
d	D	B	Dynamic (C)	Static (C <sub>0</sub> )	
50	90	44	180.4	449.9	FLW 50
55	102	75	268.5	506.0	45211
	102	100	345.8	700.5	45511
60	110	49	249.6	627.3	FLW 60
75	130	67	363.7	1047.7	FLW 75
90	160	70	507.9	1386.7	FLW 90
100	180	82	632.7	1733.5	FLW 100
	215	98	861.0	2515.9	FLW 120
130	230	110	1024.7	2946.3	FLW 130
	230	160	1024.7	2946.3	15826
140	250	120	1207.6	3735.6	FLW 140
160	290	124	1450.7	4234.5	FLW 160
180	320	149	1853.1	5601.4	FLW 180
200	340	175	2181.1	7069.0	FLW 200
	340	240	2181.1	7069.0	15740