

Needle Roller Bearings

Inner Ring
Inch Series

MI

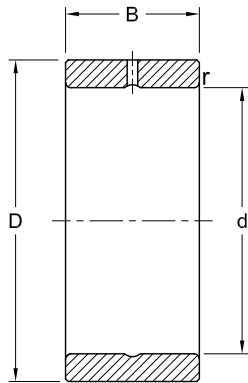

Dimensions				AEC Bearing
inch (mm)				
d	D	B	r	
0.3750	0.6245	0.7600	0.0236 (0.6)	MI 6 N
	0.6245	1.0100	0.0236 (0.6)	MI 6
0.4375	0.6245	0.7600	0.0236 (0.6)	MI 7 N
	0.7493	0.7600	0.0394 (1.0)	MI 8 N
	0.7493	1.0100	0.0394 (1.0)	MI 8
0.5625	0.7493	0.7600	0.0394 (1.0)	MI 9 N
0.6250	0.8743	0.7600	0.0394 (1.0)	MI 10 N
	0.8743	1.0100	0.0394 (1.0)	MI 10
0.6875	0.8743	0.7600	0.0394 (1.0)	MI 11 N
0.7500	0.9993	0.7600	0.0394 (1.0)	MI 12 N
	0.9993	1.0100	0.0394 (1.0)	MI 12
0.8125	0.9993	0.7600	0.0394 (1.0)	MI 13 N
	0.9993	1.0100	0.0394 (1.0)	MI 13
0.8750	1.1241	1.0100	0.0394 (1.0)	MI 14 N
	1.1241	1.2600	0.0394 (1.0)	MI 14
0.9375	1.1241	1.0100	0.0394 (1.0)	MI 15 N
	1.1241	1.2600	0.0394 (1.0)	MI 15
1.0000	1.2491	1.2600	0.0394 (1.0)	MI 16
	1.2491	1.2600	0.0394 (1.0)	MI 16 N
1.0625	1.3741	1.2600	0.0394 (1.0)	MI 17
1.1250	1.3741	1.0100	0.0394 (1.0)	MI 18 N
	1.3741	1.2600	0.0394 (1.0)	MI 18
1.1875	1.4990	1.2600	0.0591 (1.5)	MI 19
1.2500	1.4990	1.0100	0.0591 (1.5)	MI 20 N
	1.4990	1.2600	0.0591 (1.5)	MI 20
1.3125	1.6240	1.0100	0.0591 (1.5)	MI 21 N
	1.6240	1.2600	0.0591 (1.5)	MI 21
1.3750	1.6240	1.2600	0.0591 (1.5)	MI 22 4S
	1.7490	1.0100	0.0591 (1.5)	MI 22 N
	1.7490	1.2600	0.0591 (1.5)	MI 22
1.4375	1.7490	1.2600	0.0591 (1.5)	MI 23
1.5000	1.7490	1.0100	0.0591 (1.5)	MI 24 N

Dimensions				AEC Bearing
inch (mm)				
d	D	B	r	
	1.7490	1.2600	0.0591 (1.5)	MI 24
1.5625	1.8740	1.2600	0.0591 (1.5)	MI 25 4S
	1.9989	1.2600	0.0591 (1.5)	MI 25
1.6250	1.9364	1.2600	0.0591 (1.5)	MI 26 2S
	1.9989	1.0100	0.0591 (1.5)	MI 26 N
	1.9989	1.2600	0.0591 (1.5)	MI 26
1.6875	1.9989	1.2600	0.0591 (1.5)	MI 27
1.7500	2.2489	1.5100	0.0591 (1.5)	MI 28 N
	2.2489	1.7600	0.0591 (1.5)	MI 28
1.8750	2.2489	1.7600	0.0591 (1.5)	MI 30
1.9375	2.4989	1.7600	0.0787 (2.0)	MI 31
2.0000	2.4989	1.5100	0.0787 (2.0)	MI 32 N
	2.4989	1.7600	0.0787 (2.0)	MI 32
2.1250	2.4989	1.7600	0.0787 (2.0)	MI 34
2.1875	2.7489	1.7600	0.0787 (2.0)	MI 35
2.2500	2.7489	1.5100	0.0787 (2.0)	MI 36 N
	2.7489	1.7600	0.0787 (2.0)	MI 36
2.3750	2.9989	1.7600	0.0787 (2.0)	MI 38
2.4375	2.9989	1.7600	0.0787 (2.0)	MI 39
2.5000	2.9989	1.5100	0.0787 (2.0)	MI 40 N
	2.9989	1.7600	0.0787 (2.0)	MI 40
2.6250	3.2487	1.7600	0.0787 (2.0)	MI 42
2.7500	3.2487	1.7600	0.0787 (2.0)	MI 44
2.8750	3.4987	2.0100	0.0787 (2.0)	MI 46
2.9375	3.4987	2.0100	0.0787 (2.0)	MI 47
3.0000	3.4987	1.7600	0.0787 (2.0)	MI 48 N
	3.4987	2.0100	0.0787 (2.0)	MI 48
3.1250	3.7487	2.0100	0.0984 (2.5)	MI 50
3.2500	3.7487	2.0100	0.0984 (2.5)	MI 52
3.3758	3.9984	2.0100	0.0984 (2.5)	MI 54
3.5000	3.9985	2.0100	0.0984 (2.5)	MI 56
3.6250	4.2485	2.0100	0.0984 (2.5)	MI 58
3.7500	4.2485	2.0100	0.0984 (2.5)	MI 60
3.8750	4.4985	2.2600	0.0984 (2.5)	MI 62
4.0000	4.9985	2.2600	0.0984 (2.5)	MI 64
4.2500	4.9985	2.2600	0.0984 (2.5)	MI 68
4.5000	5.4985	2.5150	0.0984 (2.5)	MI 72 N
	5.4985	3.0150	0.0984 (2.5)	MI 72
4.7500	5.4985	3.0150	0.0984 (2.5)	MI 76
5.0000	5.9983	2.5150	0.1181 (3.0)	MI 80 N
	5.9983	3.0150	0.1181 (3.0)	MI 80
5.2500	5.9983	3.0150	0.1181 (3.0)	MI 84
5.5000	6.4983	2.5150	0.1181 (3.0)	MI 88 N
	6.4983	3.0150	0.1181 (3.0)	MI 88
5.7500	6.4983	3.0150	0.1181 (3.0)	MI 92
6.0000	7.2481	3.0150	0.1181 (3.0)	MI 96
6.5000	7.7481	3.0150	0.1181 (3.0)	MI 104
7.0000	8.2481	3.0150	0.1181 (3.0)	MI 112

Dimensions				AEC Bearing
inch (mm)				
d	D	B	r	
7.5000	8.7480	3.0150	0.1575 (4.0)	MI 120
8.0000	9.2480	3.0150	0.1575 (4.0)	MI 128