

Needle Roller Bearings

Without Inner Ring
Metric Series

NK, NKS, RNA

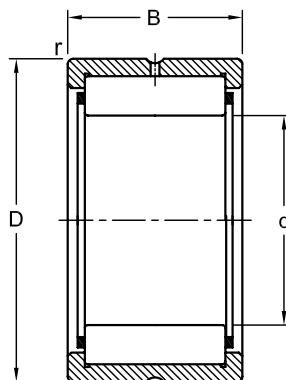

Dimensions				Load Rating		AEC Bearing
mm				kN		
d	D	B	r	Dynamic (C)	Static (C ₀)	
14	22	14	0.3	8.5	9.2	RNA 4900
	22	16	0.3	10.1	11.5	NK 14/16
	22	20	0.3	12.8	15.6	NK 14/20
15	23	16	0.3	10.7	12.7	NK 15/16
	23	20	0.3	13.6	17.2	NK 15/20
16	24	13	0.3	9.4	10.9	RNA 4901
	24	16	0.3	11.3	13.9	NK 16/16
	24	20	0.3	14.4	18.8	NK 16/20
	24	22	0.3	16.0	21.6	RNA 6901
17	25	16	0.3	11.9	15.0	NK 17/16
	25	20	0.3	15.1	20.4	NK 17/20
18	26	16	0.3	12.5	16.2	NK 18/16
	26	20	0.3	15.8	22.0	NK 18/20
19	27	16	0.3	13.0	17.4	NK 19/16
	27	20	0.3	16.5	23.6	NK 19/20
20	28	13	0.3	10.6	13.6	RNA 4902
	28	16	0.3	13.0	17.5	NK 20/16
	28	20	0.3	16.4	23.8	NK 20/20
	28	23	0.3	17.3	25.5	RNA 6902
21	29	16	0.3	13.5	18.7	NK 21/16
	29	20	0.3	17.1	25.5	NK 21/20
22	30	13	0.3	11.0	14.6	RNA 4903
	30	16	0.3	14.0	19.9	NK 22/16
	30	20	0.3	17.7	27.0	NK 22/20
	30	23	0.3	18.6	29.0	RNA 6903
24	32	16	0.3	15.0	22.3	NK 24/16
	32	20	0.3	19.0	30.5	NK 24/20
	37	20	0.6	26.0	31.0	NKS 24
25	33	16	0.3	14.9	22.4	NK 25/16
	33	20	0.3	18.8	30.5	NK 25/20
	37	17	0.3	21	25.5	RNA 4904
	37	30	0.3	36.0	51.0	RNA 6904

Dimensions				Load Rating		AEC Bearing
mm				kN		
d	D	B	r	Dynamic (C)	Static (C ₀)	
	38	20	0.6	27.5	33.5	NKS 25
26	34	16	0.3	15.3	23.6	NK 26/16
	34	20	0.3	19.4	32.0	NK 26/20
28	37	20	0.3	22.0	34.0	NK 28/20
	37	30	0.3	33.0	57.0	NK 28/30
29	42	20	0.6	28.5	36.5	NKS 28
	38	20	0.3	21.9	34.0	NK 29/20
30	38	30	0.3	32.5	57.0	NK 29/30
	40	20	0.3	22.6	36.0	NK 30/20
32	40	30	0.3	33.5	60.0	NK 30/30
	42	17	0.3	23.6	31.5	RNA 4905
35	42	30	0.3	39.0	59.0	RNA 6905
	45	22	0.6	32.0	40.0	NKS 30
37	42	20	0.3	23.1	37.5	NK 32/20
	42	30	0.3	34.5	63.0	NK 32/30
38	45	17	0.3	24.4	33.5	RNA 49/28
	45	30	0.3	40.5	63.0	RNA 69/28
40	47	22	0.6	33.5	43.5	NKS 32
	45	20	0.3	24.3	41.5	NK 35/20
42	45	30	0.3	36.5	69.0	NK 35/30
	47	17	0.3	25.0	35.5	RNA 4906
43	47	30	0.3	43.5	71.0	RNA 6906
	50	22	0.6	35.0	47.0	NKS 35
45	47	20	0.3	24.9	43.5	NK 37/20
	47	30	0.3	37.0	73.0	NK 37/30
47	52	22	0.6	36.5	50.0	NKS 37
	48	20	0.3	25.5	45.0	NK 38/20
48	48	30	0.3	38.0	76.0	NK 38/30
	50	20	0.3	26.0	47.0	NK 40/20
50	50	30	0.3	39.0	79.0	NK 40/30
	52	20	0.6	30.5	47.5	RNA 49/32
52	52	36	0.6	47.0	82.0	RNA 69/32
	55	22	0.6	38.0	54.0	NKS 40
55	52	20	0.3	26.5	49.0	NK 42/20
	52	30	0.3	39.5	82.0	NK 42/30
58	55	20	0.6	31.5	50.0	RNA 4907
	55	36	0.6	48.0	86.0	RNA 6907
60	53	20	0.3	27.0	51.0	NK 43/20
	53	30	0.3	40.5	85.0	NK 43/30
63	58	22	0.6	39.0	57.0	NKS 43
	55	20	0.3	27.5	53.0	NK 45/20
65	55	30	0.3	41.0	88.0	NK 45/30
	60	22	0.6	40.5	60.0	NKS 45
68	57	20	0.3	28.5	56.0	NK 47/20
	57	30	0.3	43.0	94.0	NK 47/30
70	62	22	0.6	43.0	67.0	RNA 4908
	62	40	0.6	66.0	116.0	RNA 6908
75	65	22	1.0	42.5	67.0	NKS 50

Dimensions				Load Rating		AEC Bearing
mm				kN		
d	D	B	r	Dynamic (C)	Static (C ₀)	
	62	25	0.6	38.0	74.0	NK 50/25
	62	35	0.6	50.0	106.0	NK 50/35
52	68	22	0.6	38.5	38.0	RNA 4909
	68	40	0.6	69.0	127.0	RNA 6909
55	68	25	0.6	40.0	82.0	NK 55/25
	68	35	0.6	53.0	118.0	NK 55/35
	72	22	1.0	45.0	74.0	NKS 55
58	72	22	0.6	47.0	80.0	RNA 4910
	72	40	0.6	73.0	139.0	RNA 6910
60	72	25	0.6	42.0	90.0	NK 60/25
	72	35	0.6	56.0	130.0	NK 60/35
	80	28	1.1	63	98	NKS 60
63	80	25	1.0	58.0	100.0	RNA 4911
	80	45	1.0	90.0	176.0	RNA 6911
65	78	25	0.6	44.0	98.0	NK 65/25
	78	35	0.6	59.0	142.0	NK 65/35
	85	28	1.1	67.0	108.0	NKS 65
68	82	25	0.6	43.5	59.0	NK 68/25
	82	35	0.6	62.0	139.0	NK 68/35
68	85	25	1.0	60.0	108.0	RNA 4912
	85	45	1.0	94.0	191.0	RNA 6912
70	85	25	0.6	44.5	92.0	NK 70/25
	85	35	0.6	63	144	NK 70/35
	90	28	1.1	68.0	113.0	NKS 70
72	90	25	1.0	61.0	112.0	RNA 4913
	90	45	1.0	95.0	198.0	RNA 6913
73	90	25	1.0	53.0	100.0	NK 73/25
	90	35	1.0	75	156	NK 73/35
75	92	25	1.0	54.0	104.0	NK 75/25
	92	35	1.0	77.0	162.0	NK 75/35
	95	28	1.1	71.0	123.0	NKS 75
80	95	25	1.0	56.0	119.0	NK 80/25
	95	35	1.0	78.0	184.0	NK 80/35
	100	28	1.1	75.0	133.0	NKS 80
	100	30	1.0	84.0	156.0	RNA 4914
	100	54	1.0	128.0	265.0	RNA 6914
85	105	25	1.0	69.0	123.0	NK 85/25
	105	30	1.0	86.0	162.0	RNA 4915
	105	35	1.0	98.0	193.0	NK 85/35
	105	54	1.0	130.0	275.0	RNA 6915
90	110	25	1.0	72.0	132.0	NK 90/25
	110	35	1.0	89.0	174.0	RNA 4916
	110	35	1.0	103.0	208.0	NK 90/35
	110	54	1.0	135.0	300.0	RNA 6916
95	115	26	1.0	73.0	137.0	NK 95/26
	115	35	1.0	107.0	223.0	NK 95/36
100	120	26	1.0	76.0	146.0	NK 100/26
	120	35	1.1	111.0	124.0	RNA 4917

Dimensions				Load Rating		AEC Bearing
mm				kN		
d	D	B	r	Dynamic (C)	Static (C ₀)	
105	120	36	1.0	111.0	237.0	NK 100/36
	120	63	1.1	166.0	400.0	RNA 6917
	125	26	1.0	78.0	155.0	NK 105/26
	125	35	1.1	114.0	250.0	RNA 4918
	125	36	1.0	114.0	250.0	NK 105/36
110	125	63	1.1	172.0	425.0	RNA 6918
	130	30	1.1	98.0	210.0	NK 110/30
	130	35	1.1	116.0	260.0	RNA 4919
	130	40	1.1	127.0	290.0	NK 110/40
115	130	63	1.1	174.0	440.0	RNA 6919
	135	32	1.1	91.0	204.0	NKS 115
	140	40	1.1	128.0	270.0	RNA 4920
125	150	40	1.1	132.0	29.0	RNA 4922
135	165	45	1.1	181.0	390.0	RNA 4924
150	180	50	1.5	203.0	470.0	RNA 4926
160	190	50	1.5	209.0	500.0	RNA 4928